

Main Street Memo

Transom Windows

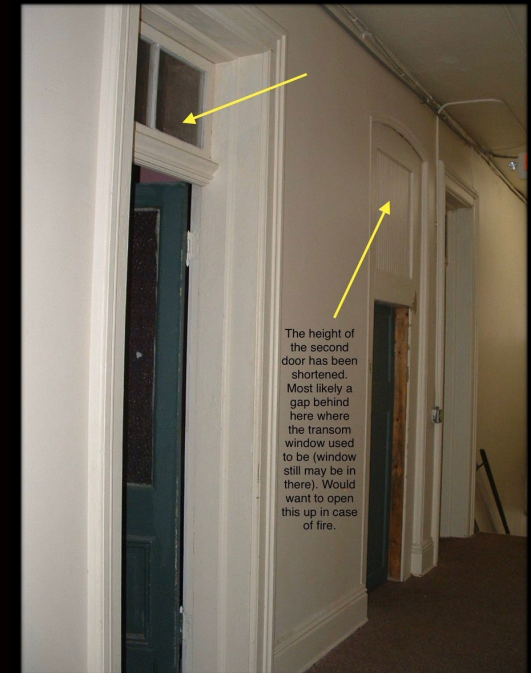

Overhead hazards: Transom window converted for an AC unit



-Transom windows are a legacy building characteristic designed to move air prior to HVAC

-Allows fire spread into living spaces from common areas and vice versa

-Shelter in place will not be a dependable option

-May be painted over or covered during remodels

-The failure of transom windows contributed to a rapid fire spread at the Our Lady of Angels fire which occurred in Chicago, December 1st, 1958.

All Photos by Chris Tobin, Lexi Shady and Joe Pronesti

